

'Le Commandant Charcot' Deck Plan

- Category 1
Classic Stateroom
 - Category 2
Superior Stateroom
 - Category 3
Prestige Stateroom
 - Category 4
Deluxe Stateroom
 - Category 5
Prestige Two-Room Suite
 - Category 6
Grand Prestige Suite
 - Category 7
Privilege Two-Room Suite
 - Category 8
Duplex Suite
 - Category 9
Owner's Suite
- BUTLER SERVICE INCLUDED

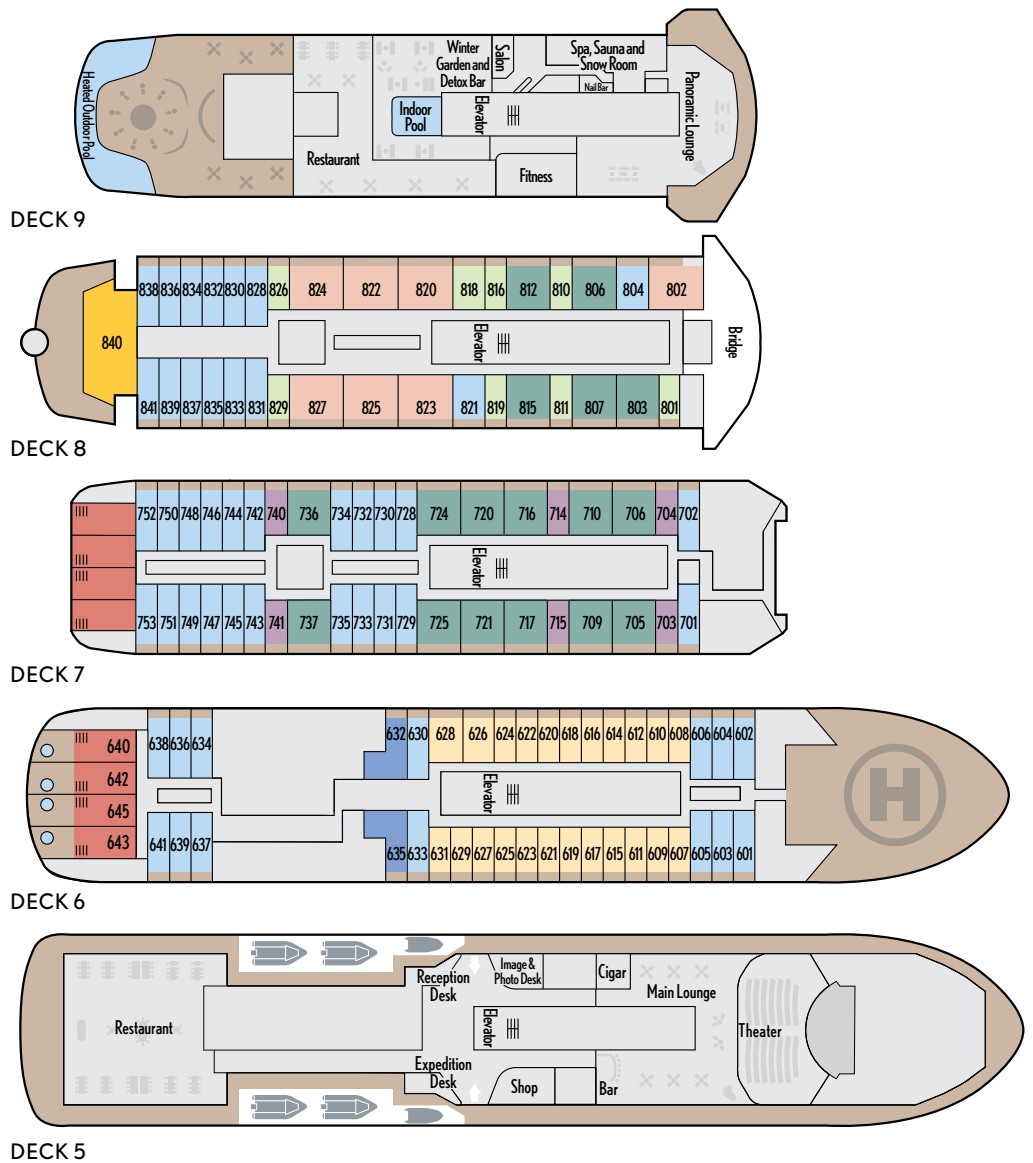

'Le Commandant Charcot' Cabin Layouts

BUTLER SERVICE INCLUDED

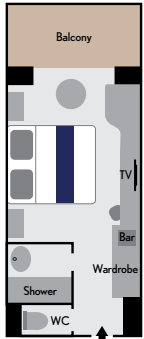

Categories 1-3
Staterooms

Cabin: 215 sq. ft. (20 sq. m.)
Balcony: 53 sq. ft. (5 sq. m.)

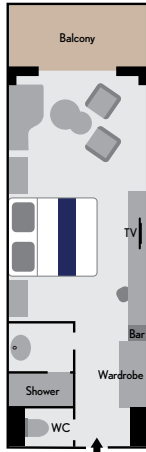

Category 4
Deluxe Stateroom

Cabin: 301 sq. ft. (28 sq. m.)
Balcony: 53 sq. ft. (5 sq. m.)

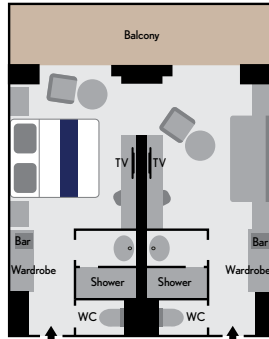

Category 5
Prestige Two-Room Suite

Cabin: 430 sq. ft. (40 sq. m.)
Balcony: 107 sq. ft. (10 sq. m.)

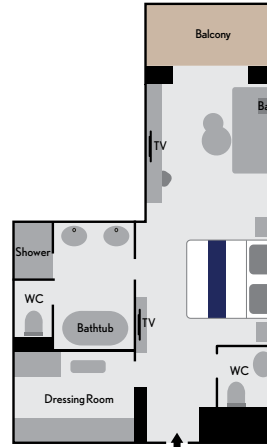

Category 6
Grand Prestige Suite

Cabin: 452 sq. ft. (42 sq. m.)
Balcony: 54 sq. ft. (5 sq. m.)

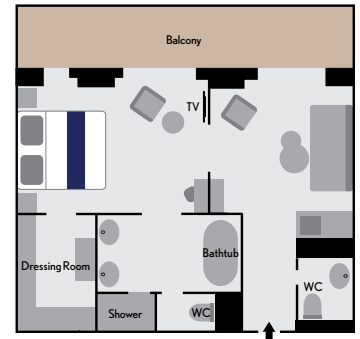

Category 7
Privilege Two-Room Suite

Cabin: 516 sq. ft. (48 sq. m.)
Balcony: 134.5 sq. ft. (12.5 sq. m.)

BUTLER SERVICE INCLUDED

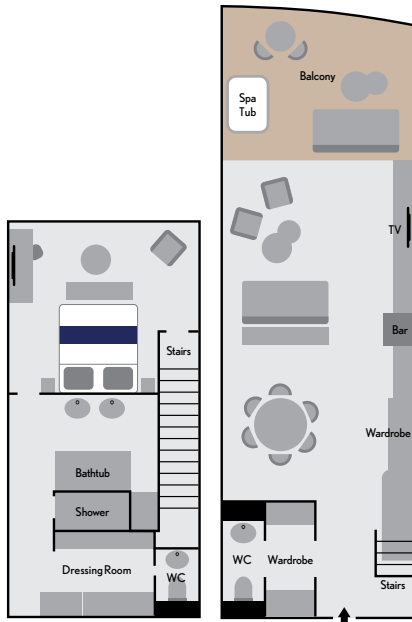

Category 8
Duplex Suite

Cabin: 1,011 sq. ft. (94 sq. m.)
Balcony: 279 sq. ft. (26 sq. m.)

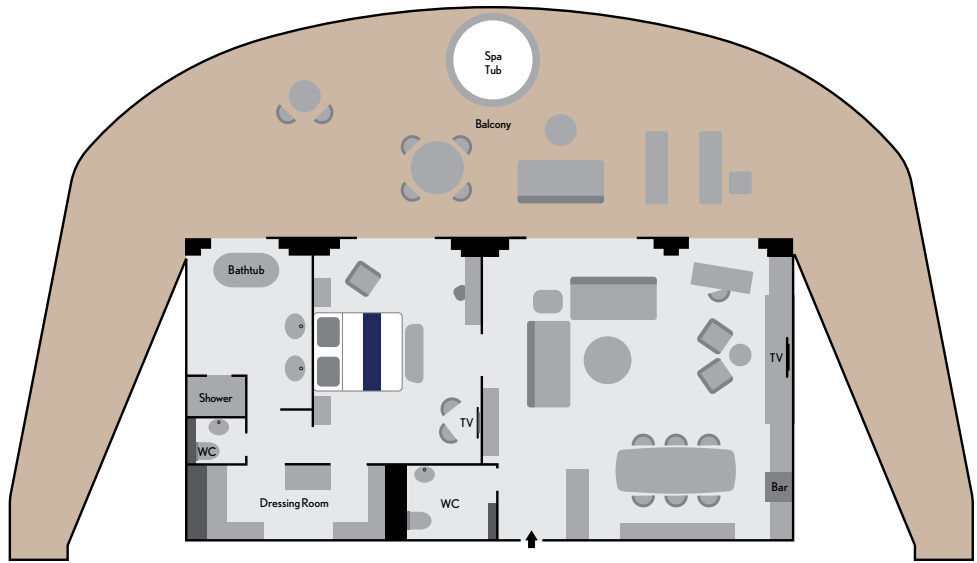

Category 9
Owner's Suite

Cabin: 1,237 sq. ft. (115 sq. m.)
Balcony: 2,002 sq. ft. (186 sq. m.)

'Le Commandant Charcot' Gallery

Stateroom and Suites



Stateroom



Deluxe Stateroom



Prestige Two-Room Suite



Grand Prestige Suite



Privilege Two-Room Suite



Duplex Suite



Owner's Suite

Common Areas



Theater

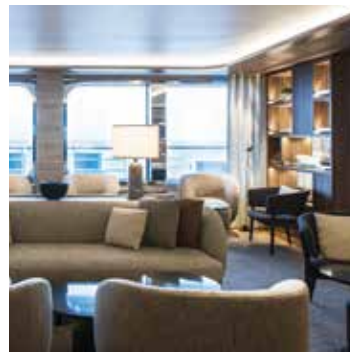

Main Lounge



Panoramic Lounge



Main Restaurant



Snow Room



Indoor Pool



Fitness Room



Sauna